

# Basement Detail

## TYPICAL BASEMENT BENEX WALL DETAIL

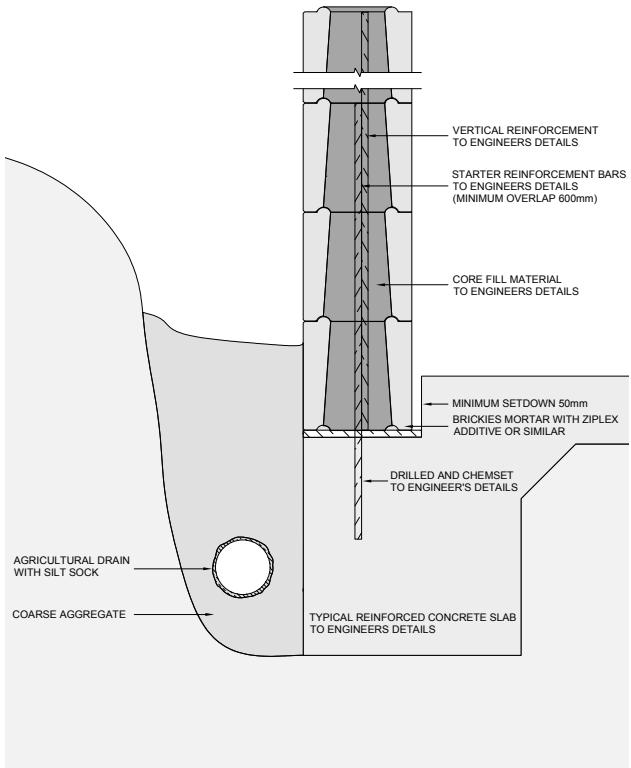

The Benex Wall Construction System being resistant to salt attack is the ideal solution for basement walls with reduced excavation required and no need to waterproof, Benex will save you both time and money on your next project.

Excavation can be reduced from 750mm to 150mm leaving enough room for ag pipe drainage and reducing the need for backfill.